



CEDARSHED INSTRUCTIONS



FERNDALE - SHINGLE ROOF

Base size: 1900mm x 1800mm deep

FERNDALE

Tools Required:

- Battery Drill
- Riveter
- Hammer
- Tape Measure
- Ladder
- Skillsaw
- Level
- Screwdriver - Flat
- 3/8 Hex Drive bit
- Drill Bit 3.2mm

Before you start:

- Read all instructions carefully.
- Identify all parts and check quantities against checklist.

Safety:

- Do not attempt to build your shed in high winds.
- Beware of sharp edges.
- Protect your eyes and ears.
- Use electric tools with care. Use a Safety Trip Switch.
- It is easier and quicker if this shed is erected by two people.

Select your site:

- Your shed must be level. Achieve this by either levelling the ground or by using blocks.

FERNDALE PARTS LIST

Description	Size	Qty	
PACK ONE - ROOF			
Shingle Roof Panels	1900 x 1100	2	<input type="checkbox"/>
PACK TWO - SHED			
Standard Door	895 x 1780	1	<input type="checkbox"/>
Side Wall Panels	900 x 1937	4	<input type="checkbox"/>
Back Wall Gable Panels	900 x 2330	2	<input type="checkbox"/>
Door Gable Panel LH & RH	900 x 2330	2	<input type="checkbox"/>
Cedar Corner Clashings	65 x 17 x 1962	4	<input type="checkbox"/>
30 x 17 Std Cedarbead	30 x 17 x 1937	2	<input type="checkbox"/>
15 x 17 Std Cedarbead	15 x 17 x 1937	4	<input type="checkbox"/>
30 x 17 Gable Cedarbead	30 x 17 x 2330	1	<input type="checkbox"/>
30 x 17 Gable Cedarbead	30 x 17 x 415	1	<input type="checkbox"/>
15 x 17 Gable Cedarbead	15 x 17 x 1920	2	<input type="checkbox"/>
Bargeboards	90 x 17 x 1170	4	<input type="checkbox"/>
Door Stop	45 x 45 x 900	1	<input type="checkbox"/>
Door Lintel	167 x 900	1	<input type="checkbox"/>
Stiffeners	45 x 45 x 1800	2	<input type="checkbox"/>
Ridge Flashing	240 x 1900	1	<input type="checkbox"/>
Ply Gussets	400 x 98 x 12	2	<input type="checkbox"/>
Weatherstrip	50mm x 20m Roll	1	<input type="checkbox"/>
Silicone Tube	300g	2	<input type="checkbox"/>
Diamonds	230 x 95 x 17	2	<input type="checkbox"/>
20mm Packer	20 x 45 x 1720	1	<input type="checkbox"/>
Hardware Pack			
Tek Screws	14G x 75mm, CL4	50	<input type="checkbox"/>
Framing Nails	75 x 3.15mm	30	<input type="checkbox"/>
Bead Nails	50 x 2.5mm	105	<input type="checkbox"/>
Clouts	30 x 2.5mm	60	<input type="checkbox"/>
Door Handle		1	<input type="checkbox"/>
Door Latch		1	<input type="checkbox"/>
Door Handle Screws	3/16 x 2.5"	2	<input type="checkbox"/>
Instructions		1	<input type="checkbox"/>
PACK THREE - FLOOR (if required)			
Floor Joists	70 x 45 x 1790	5	<input type="checkbox"/>
Floor Boards	150 x 19 x 1885	12	<input type="checkbox"/>
Floor Nails	50 x 2.5mm	120	<input type="checkbox"/>

Packed by:

Date: / /



FERNDALE FLOOR - OPTIONAL

Step 1: Lay out floor joists, spacing them evenly as shown. Using 50mm flooring nails, nail a floor board on each end, ensuring ends are flush with joists. Make sure floor is level and joists are supported at 900mm centres.



Step 2: Lay out remaining floor boards. Measure diagonals to ensure measurements are equal (i.e. floor is square). Rip down last floor board to suit gap, and nail off floor with 50mm flooring nails (10 nails per board).



Step 3: Nail plastic weather strip to edge of floor on all four sides, with 30mm flathead nails, (approx 5 nails per side) ensuring top edge is flush with top of floor. This isn't required if shed is on a concrete base.



Step 4: Unpack panels and identify wall panels and door positions as per plan on following page. Select two panels that go either side of a corner (gable and standard panel) and stand together.



FERNDALE CONCRETE FLOOR - OPTIONAL

Building a Raised Concrete Base

Step 1: Establish size of shed and excavate sufficient area. Remember to allow for rear roof overhang up to 150mm, and 120mm on each end.

Step 2: Ensure that the base substrate is compacted firmly. We suggest that the slab should be 80mm thick in the middle and 100mm thick around the edges.

Step 3: Lay boxing to the required size, the raised slab size should be 1885 x 1785mm and at least 30mm above the ground line.



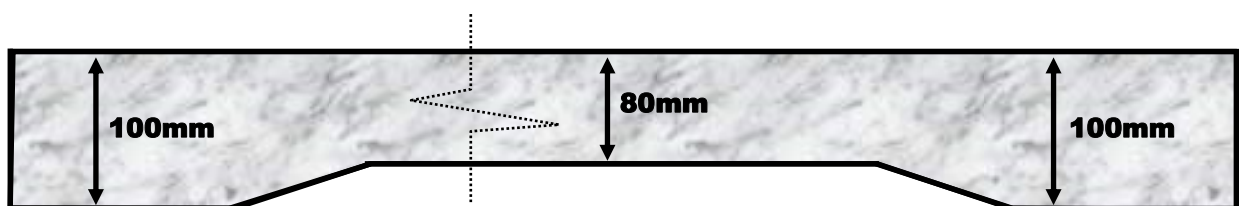

Step 4: Lay plastic sheeting if required. Plastic sheeting under slab will prevent moisture coming through from underneath.

Step 5: Pour concrete and screed flush

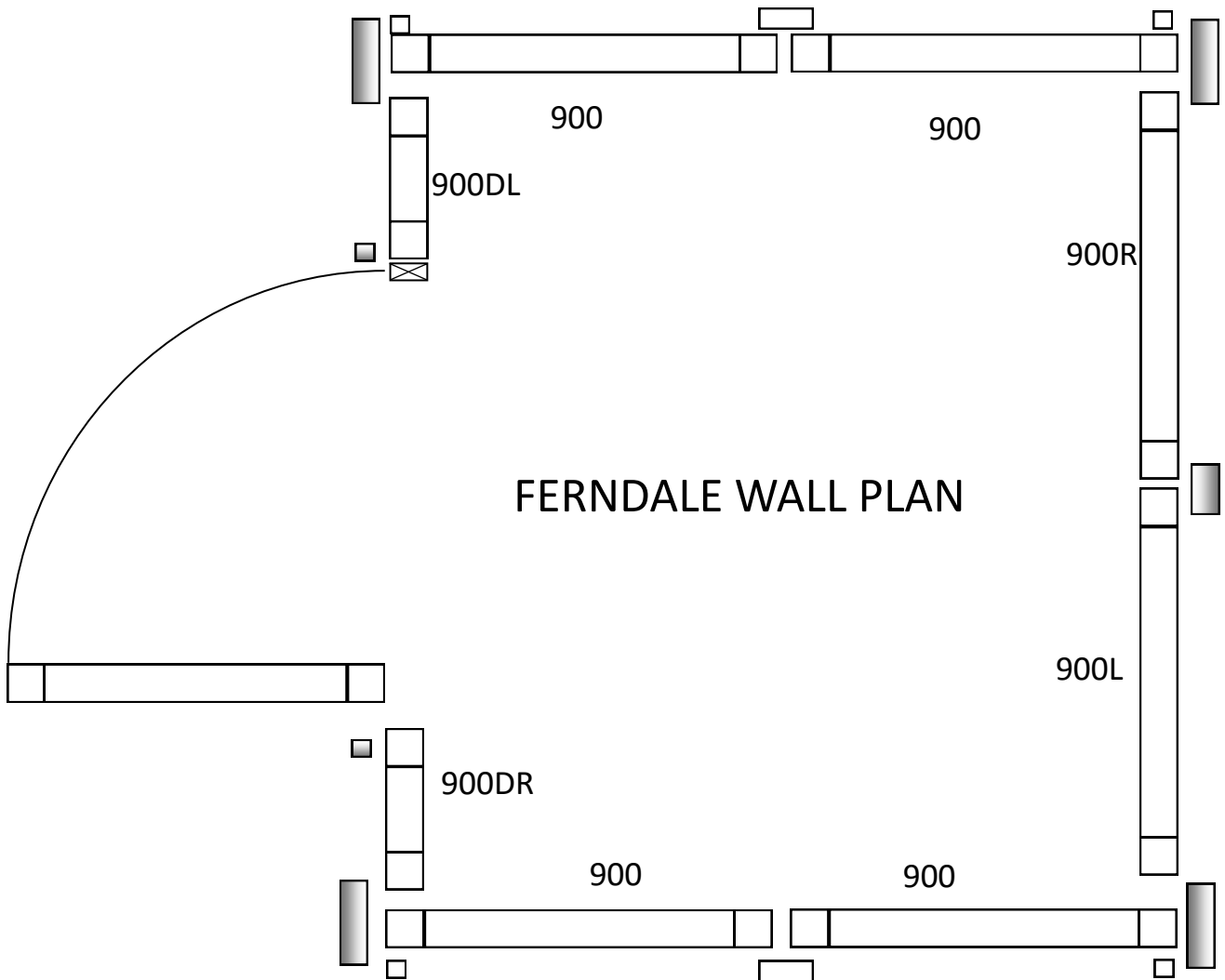

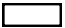
FERNDALE WALL PLAN



- | | |
|----------------------------|---|
| 15 x 17mm Std Cedar bead |  |
| 30 x 17mm Std Cedar bead |  |
| 15 x 17mm Gable Cedar bead |  |
| 30 x 17mm Gable Cedar bead |  |
| Corner Clashing |  |
| 45 x 20mm Packer |  |

FERNDALE WALLS

Step 5: Screw wall panels together using 75mm tek screws (3 per panel), ensuring end wall panels are inside side wall panels as per wall plan.

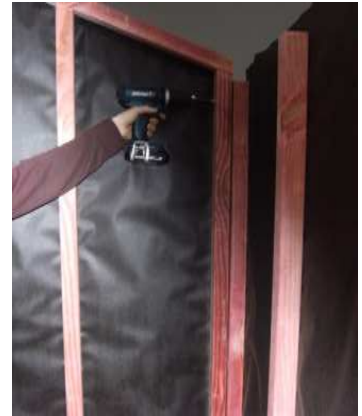

Step 6: Silicone edge of weatherboards on standing panel and nail on cedar beads with 5 x bead nails. (Refer to wall plan for correct beads).

Make sure bead is properly sealed to avoid leaks.

Note: On standard panels only, top of bead is bevelled to allow for slope of roof.



Step 7: Silicone and nail remaining beads on each panel. Screw panels together using 3 tek Screws per join and 4 on the longer joins on gable end panels.



FERNDALE TOP STIFFENER

Step 8: Using 75mm framing nails, nail both top plate stiffeners into standard wall panels studs, as shown using 2 nails per stud. Ensure ends are flush before nailing.



Step 9: Using 30mm clouts nail top cedar boards to stiffeners (2-3 per board). Pre-drill holes to stop boards from splitting.



FERNDALE TOP LINTEL

Step 10: Using 4 x 75mm tek screws screw door lintel to studs. Ensure outside cedar weatherboard on lintel is flush with weatherboards each side.

Note: You may have to loosen screws joining gable end panels to fit lintel in position.



Door lintel shown from inside



Door lintel shown from outside.

Silicone and fit 30mm bead above door way, using bead nails.

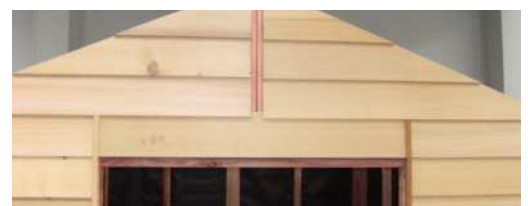

FERNDALE CORNER CLASHINGS

Step 11: Silicone and nail 15 x 17mm beads on all corners as shown using 5 x 50mm beading nails, per bead.



Step 12: Silicone and nail corner clashings on all corners as shown using 5 x bead nails per clashing.

Silicone both edges of clashing to ensure this doesn't leak.



FERNDALE ROOF

Step 13: Ensure shed is square, by measuring diagonals at top corner of wall panels.

Position roof panels on shed as shown.

Note: Model shown is the Logan shed.



Step 14: Using 75mm tek screws, screw roof panels into end wall panels, (2 screws each end per panel), ensuring end of rafter lines up with centre of gable panel.



Step 15: Using 2 x 75mm framing nails, nail centre rafter to front and back top plate stiffeners. Pre-drill if necessary.



FERNDALE ROOF

Step 16: Attach a plywood gusset to each side of rafter as shown using 8 x 30mm clouts per side.



Step 17: Attach ridge flashing to shingle roof panels with 30mm clouts nailing into top purlin at approx 300mm centres.



FERNDALE BARGE

Step 18: Nail barge boards to ends of purlins, using 50mm bead nails. (1 nail per purlin).

Nail diamonds to barges with 2 x 50mm bead nails.



FERNDALE DOOR

Step 19: Fit door stop in doorway. Check all wall panels are straight and panels either side of doorway are tight against door stop. Screw panels to floor using 1 x 75mm tek screw per panel. Screw near the panel joins, where possible. Nail door stop to floor using 75mm framing nails.



Step 20: Fit door in position as shown.



Step 21: Using 3 x 75mm tek screws, screw door stud to panel ensuring height is correct.



Check that door opens and closes correctly and height is correct.

Fit handle as shown. Attach with 2 x handle screws. Attach and tighten latch to square shaft



Using 5 x 50mm beading nails, nail 20mm packer onto side of door opening as shown in Wall plan on pg. 5.

FERNDALE

Your shed is now complete. You may protect Cedar by staining cedar weatherboards if required.



CEDAR SHED WARRANTY

GUARANTEE TO CUSTOMER

Congratulations on purchasing a quality New Zealand made Cedar Shed manufactured by Riverlea Group Limited. With proper care and attention this product will offer you many years of use.

WARRANTY ON METAL CLADDING

Your new shed is guaranteed for the benefit of the original purchaser, against defective material or faulty workmanship for **fifteen years** from date of purchase. Riverlea Group Limited will, at its discretion, replace or repair any faulty or defective materials within this time on condition that due care and maintenance has been carried out as detailed below.

TERMS AND CONDITIONS

This warranty does not cover Cedar sheds with steel roofing if it is installed outside the inland corrosion zone or areas where the corrosion rate is more than 200g/m² (as published by BRANZ)

1. The warranty does not cover damage or failure due to improper assembly.
2. This warranty does not cover damage through force majeure or other cause beyond the control of Riverlea Group Limited.
3. This warranty is void if maintenance as detailed below and in the assembly manual has not been adhered to.
4. This warranty does not cover natural variations, expansion, contractions as can be reasonably expected from a timber product.

Painting or coating of your Cedar Shed with a dark colour will cause increased timber temperature and movement which will render this warranty null and void.

Beyond the exclusions above, Riverlea Group Limited will repair or replace the damaged or faulty product. The balance of the original warranty will cover any repaired or replaced material. Riverlea Group Limited will not be liable for any consequential loss or damage, labour or transport costs. All claims must be made within 21 days of discovery.

MAINTENANCE

The following are the minimum maintenance requirements for Cedar Sheds manufactured by Riverlea Group Limited. Please refer to your assembly manual for more details.

Immediately coat all cedar walling cladding with "Endurance Cedar Wall Protector". Cedar walls are to be regularly recoated according to application instructions on the product packaging.

Immediately coat all cedar shingle roofing with "Endurance Cedar Shingle Protector" Cedar shingles are to be regularly recoated according to application instructions on the product packaging.

All steel roofing is to be kept clean and free of debris and washed annually with a hose and soft brush.

Timber floors, where supplied are to be kept out of direct water contact or runoff

The above guidelines will guarantee you a superior Cedar Shed that will offer you many years of outstanding usefulness.

WARRANTY REGISTRATION

Please visit <http://www.riverleagroup.co.nz/warranty-garden-sheds> to validate the Warranty on your shed.

Click on the Warranty Registration Link and complete all details.

If you are unable to access the computer, please phone us on 0800 438 274 and one of the customer services team will help you to activate the warranty on your garden shed.

Many thanks, from the Team at Riverlea Group.

